

Redland

Redland GRP Secret Gutter
Product Code: 9596

Suitable for Pitches
between 15 and 90 degrees

1

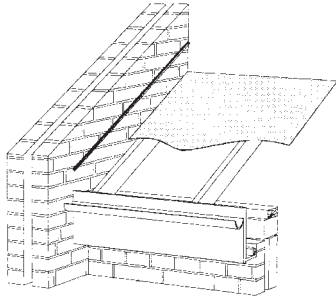

Finish underlay 50mm up abutment.

2

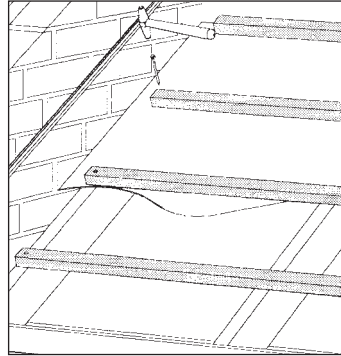

Finish tiling battens 55mm from wall and nail fix to final rafter. If final rafter is less than 55mm from wall, fix a supplementary timber noggin (50 x 50mm) to the side of, and flush with, the top of the final rafter to support the battens.

3

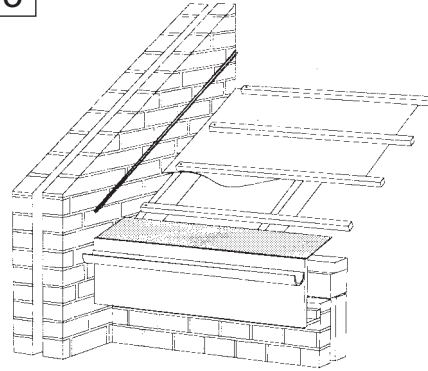

Fix timber tilting filler to support lead gutter outlet at base of secret gutter.

4

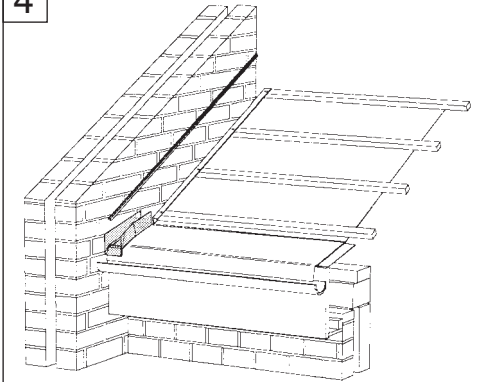

Fix code 4 or 5 lead gutter outlet onto tilt gutter ensuring that water is discharged into the gutter.

5

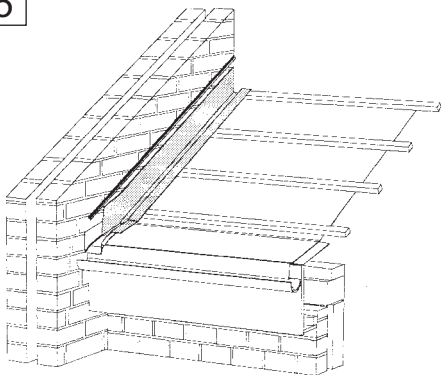

Starting at eaves, ensure that the first secret gutter section overlaps the lead gutter outlet by 150mm.

Each secret gutter section should overlap the one below by the length stated in table 6.

6

Pitch °	12.5 – 14.5	15 – 17	17.5 – 22	22.5 – 29.5	30 +
Length (in mm)	350	300	250	200	150

This table shows overlap against pitch range.

7

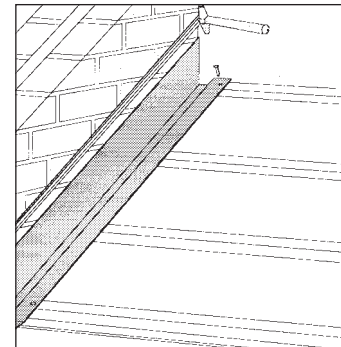

Using clout beaded nails, nail secret gutter to every third tiling batten through 8mm drilled holes.

8

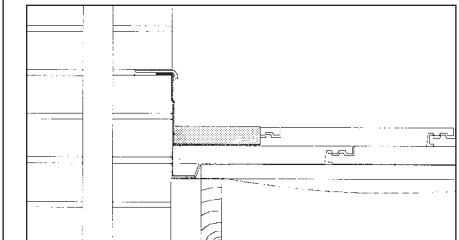

Lay slates as normal ensuring a maximum gap of 15mm to the wall. It may be necessary to remove the end nib to ensure the tiles sits properly.

Dress a code 4 or 5 lead cover flashing closely over the slates, by no less than 150mm, and up the wall before turning into a brick joint or slot.